

Balloon Centerpiece Instructions

Step 1

Inflate balloons with air.

*Inflate with compressed air, hand pump (sold separately) or by blowing into straw included in package.

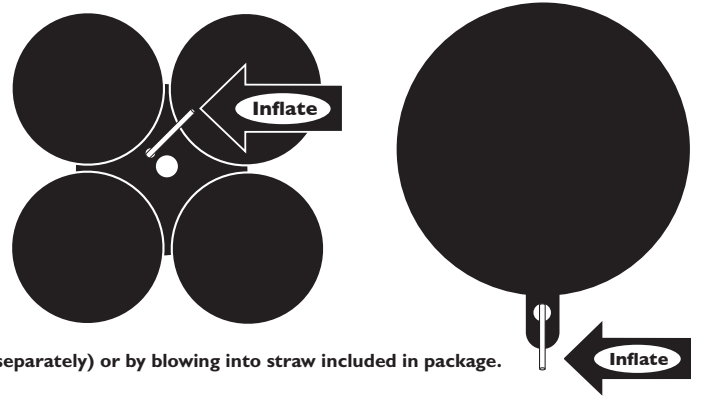

Step 2

Secure main balloon to cup by following numbers in the diagram.

- 1 Insert tail of balloon into top of cup and out the hole on side of cup.
- 2 Wrap tail around cup.
- 3 Tuck tail back inside cup to secure in place.
- 4 Insert straw into bottom of cup.

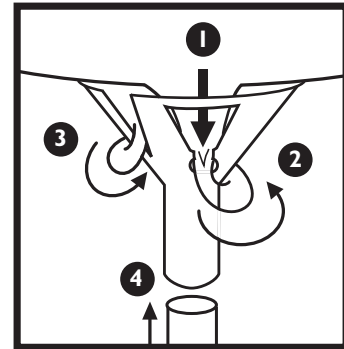

Step 3

- 1 Insert straw down through center of foil fringe and out the bottom
- 2 Slide 1st cardboard disc onto straw so that disc butts up against bottom portion of foil fringe.
- 3 Insert straw through hole of each MagicArch™ balloon. Rotate each balloon to fit together as shown.
- 4 Slide 2nd cardboard disc onto straw to fit snugly against bottom of MagicArch™ balloon.
- 5 Insert straw into 2nd cup to secure components together.

